



Nano SPY Reference

The most accurate T° sensor in the Nano SPY range to meet your demanding measurement needs and provide metrological services (calibration and mapping).



Non contractual photo

Presentation

A reference device designed to perform calibrations of connected loggers in the Nano SPY range, the Nano SPY Reference recorder measures and records temperature with high precision and has a 3m cryogenic probe.

Its metrological specificities allow it to be perfectly adapted to the monitoring of equipment with very limited temperature ranges.

Technical features

| | |
|-----------------------------------|---|
| Interface | Status LED and On/Off touch button |
| Measurement range | -50°C to +200°C |
| Accuracy | +/-0.15°C between -40°C and +80°C. The rest of the range can be specified by COFRAC calibration with a minimum of 5 points, coupled with modeling. |
| Communication frequency | 2,4 GHz (802.15.4) |
| Memory | 10 000 data points |
| Sensor | External Class A PT 100 - stainless steel Ø2,9x25mm 3m cable lenght |
| Operating conditions | -20°C to +50°C |
| Resolution | 0.01 |
| Measuring and transmission period | 1 mn |
| Internal memory recording period | Adjustable from 1 mn to 24 hrs |
| Response time σ_{63} | ~ 30s |
| Protection | IP65 |
| Case | Polycarbonate – Food contact |
| Power supply | Lithium 3,6v battery - Replaceable |
| Battery life | 6 years |
| Dimensions and weight | 63 x 42 x 25 mm / ~ 60 g |
| Fixation | Fixing eyelets and integrated magnets |
| Supplied with | Brown identification ring User manual can be download on www.jri-corp.com |
| Compliance | CE, ROHS, FCC, ETS 300-328 |
| Standard calibration points | -30°C / 0°C / +30°C / +60°C |

Atouts

- Excellent measurement quality
- Operation and alarm LEDs



- Magnet or eyelet mouting



- Autonomous thanks to tool-free battery replacement

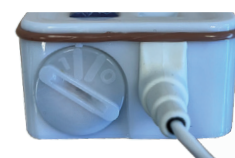

PART NRS
12521 E : Nano SPY Reference
12521 X : Nano SPY Reference without battery

FT 12521 EN B



Protective shell (included by default)
Part nr. 12715

The protective shell is used to protect all Nano SPY mini-data loggers from shocks.
It is supplied with a double-sided adhesive to be glued to all surfaces and an anti-theft screw for the Nano SPY.
It can also be screwed (screws not supplied).

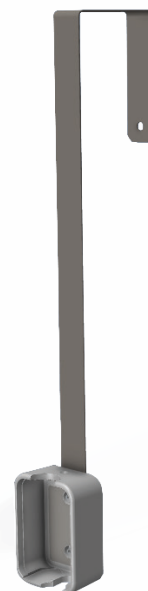

Caliper for protective shell
Part nr. 12716

The caliper is designed for the fixing of a protective shell of Nano SPY on cabinets with horizontal opening to facilitate cleaning operations.
The protective shell of Nano SPY can be directly glued to the bottom of the bracket and/or fixed with screws (provided).