



Nano SPY T2

Mini Temperature Data Logger 2,4GHz Radiofrequency Communication



Non contractual photo

Presentation

The Nano SPY T2 measures and records temperature with its external probe. It transmits the data to a nearby LINK module via 2.4 GHz radio frequency communication.

The data are then automatically sent to the JRI secure Cloud for hosting, and can be managed from the JRI MySirius web application.

If thresholds are exceeded, alerts are transmitted in real time to react immediately.

Designed to monitor thermo-controlled chambers, the sensor can be fixed thanks to its magnet outside of the equipment.

Technical features

	Standard Version	Incubator Version
Interface	Status LED and On/Off touch sensitive button	
Measurement range	-50°C to +105°C	+30°C to +50°C
Accuracy	±0.3°C from -20°C to +30°C and ±0.5°C out of this range	±0.2°C
Communication frequency	2,4 GHz (802.15.4)	
Memory	10 000 data points	
Temperature sensor	External PT100 probe - Ø5x20mm	
Operating conditions	-30°C to +70°C	
Resolution	0.01	
Measuring and transmission period	1 mn	
Internal memory recording period	Adjustable from 1 mn to 24 hrs	
Response time σ_{90}	~2 mn at 90% of the variation	
Protection	IP65	
Case	Polycarbonate – Food contact	
Dimensions and weight	63 x 42 x 25 mm / ~ 60 g	
Cable lenght	30 cm, 3m or 8m	30 cm or 3m
Power supply	3,6v Lithium battery - Replaceable	
Battery life	6 years	
Fixation	Fixing eyelets and integrated magnets	
Supplied with	Blue JRI identification ring	Yellow identification ring
	User manual can be download on www.jri-corp.com	
Compliance	CE, ROHS, FCC, ETS 300-328, EN 12830	
Standard calibration points	-18°C / +6°C / +22°C	+36°C / +38°C / +45°C

Benefits

- **Easy-to-use**
The sensor is ready to use and has operating and alarm lights



- **Excellent measurement accuracy**



Fixing eyelets



Replaceable battery and non-disconnectable probe



Incubator Version

Part Numbers

STANDARD PART NUMBERS

11569 2E : Nano SPY T2 30cm
11570 2E : Nano SPY T2 3m
11571 2E : Nano SPY T2 8m

Models without battery:

11569 2X : Nano SPY T2 30cm
11570 2X : Nano SPY T2 3m
11571 2X : Nano SPY T2 8m

INCUBATOR PART NUMBERS

11569 2IE : Nano SPYT2 30cm
11570 2IE : Nano SPY T2 3m

Models without battery:

11569 2IX : Nano SPY T2 30cm
11570 2IX : Nano SPY T2 3m

Accessories



Protective shell
Part nr. 12715

Protective shell

The protective shell is used to protect all Nano SPY mini-data loggers from shocks.

It is supplied with a double-sided adhesive to be glued to all surfaces and an anti-theft screw for the Nano SPY.

It can also be screwed (screws not supplied).

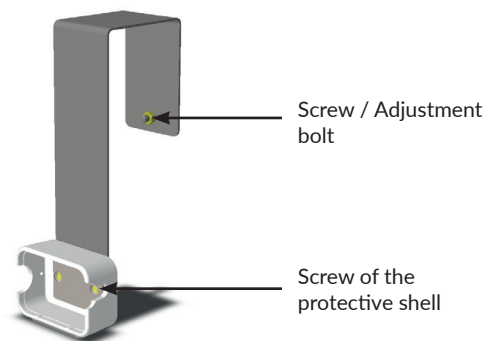

Caliper for protective shell
Part nr. 12716

Caliper for protective shell

The caliper is designed for the fixing of a protective shell of Nano SPY on cabinets with horizontal opening to facilitate cleaning operations.

The caliper can be mounted on 65mm wide walls (without the screw + adjustment bolt).

The protective shell of Nano SPY can be directly glued to the bottom of the bracket and/or fixed with screws (provided).